



**1/15-17 Charles Street St Marys NSW**

**2**

PRD Commercial Western Sydney have been appointed Exclusive Marketing Agents to offer the Rise Industrial Estate located at 15-17 Charles St, St Marys.

The Rise Industrial Estate is strategically positioned in the thriving business hub of St Marys. The estate forms part of the booming Western Sydney industrial region.

The unit features the following:

- Front unit with street appeal
- Architecturally Designed with high quality finishes
- Internal ceiling height of 6.5m
- 2 car spaces
- Automatic container height roller door (height 5m)
- Insulated metal deck ceiling
- Excellent natural lighting
- Unique end of trip facilities on site

**Building Size** : 190 sqm

**View**

: <http://www.prdcommercialwest.com.au/sale/nsw/western-sydney/st-marys/commercial/industrial/5615866>

# RISE INDUSTRIAL ESTATE

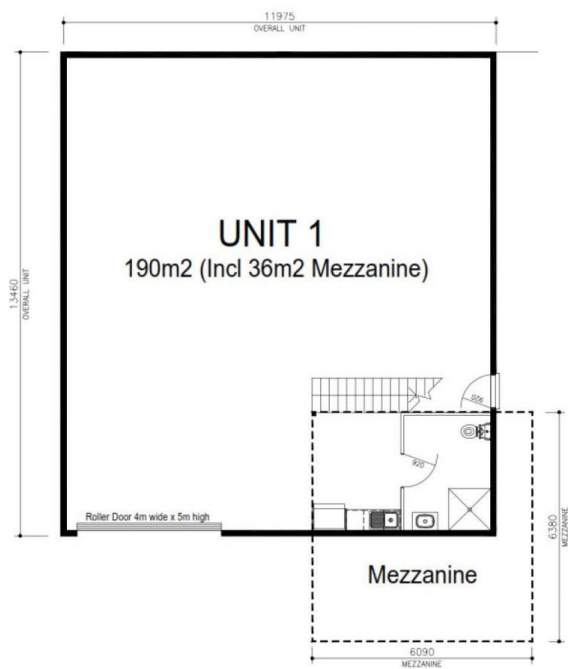

**RISE PROJECTS**

	<b>UNIT 1</b>
<b>GROUND FLOOR AREA</b>	<b>154m<sup>2</sup></b>
<b>MEZZANINE AREA</b>	<b>36m<sup>2</sup></b>
<b>TOTAL AREA</b>	<b>190m<sup>2</sup></b>

DISCLAIMER: The plan shown is a depiction of the floor plans. Due to the shape of the building, each floor plan will vary slightly. This document provides general information only, including illustrations, computer-generated images and forward-looking statements which are made on the basis of currently-available information and reasonable beliefs, but are subject to change at any time without notice. All properties are subject to contract and availability. The area (in square meters) is approximate. To the extent permitted by law, Rise Projects Pty Ltd and its related companies, directors and employees exclude all representations, warranties and liability whatsoever (including negligence) in connection with this document.