



Unit 13/15-17 Charles Street St Marys NSW

2 🚗

PRD Commercial are proud to offer this brand new industrial warehouse located in the Dunheved Cct precinct for lease.

Features Include:

- 171m2 (approx) high clearance warehouse
- Container height electric roller door
- Well presented with concrete panels and modern façade
- Unisex bathroom including toilet and shower
- 2 car spaces
- Ready to occupy today

Contact the team at PRD Commercial to inspect today.

Note: All building and land areas quoted are approximate; prospective purchasers and tenants must make their own enquiries. All sale prices and asking rentals DO NOT

Building Size : 171 sqm
View : <http://www.prdcommercialwest.com.au/lease/nsw/western-sydney/st-marys/commercial/industrial/5615934>

RISE INDUSTRIAL ESTATE

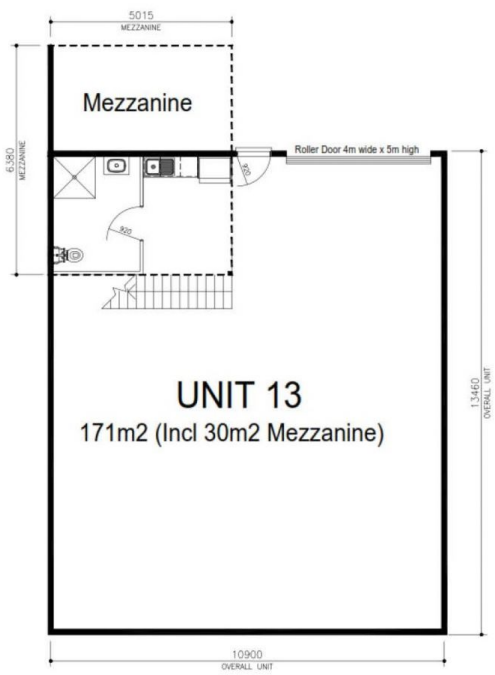

	UNIT 13
GROUND FLOOR AREA	141m ²
MEZZANINE AREA	30m ²
TOTAL AREA	171m ²

DISCLAIMER: The plan shown is a depiction of the floor plans. Due to the shape of the building, each floor plan will vary slightly. This document provides general information only, including illustrations, computer-generated images and forward-looking statements which are made on the basis of currently-available information and reasonable beliefs, but are subject to change at any time without notice. All properties are subject to contract and availability. The area (in square meters) is approximate. To the extent permitted by law, Rise Projects Pty Ltd and its related companies, directors and employees exclude all representations, warranties and liability whatsoever (including negligence) in connection with this document.