



1/15-17 Charles Street St Marys NSW

PRD Commercial are offering for the first time the front unit in the prestigious Rise Industrial Estate, St Marys for lease.

Mezzanine 43m2
Warehouse 154m2

Total 197m2

Features Include:

- ? High clearance warehouse approximately 6.5m
- ? Container height roller door approximately 5m
- ? Front unit of complex offering exposure and lots of natural light
- ? Modern and well constructed warehouse at front of complex
- ? Toilet, Shower and Kitchenette
- ? Zoned IN1

Building Size : 197 sqm

View

: <http://www.prdcommercialwest.com.au/lease/nsw/western-sydney/st-marys/commercial/industrial/5778935>

RISE INDUSTRIAL ESTATE

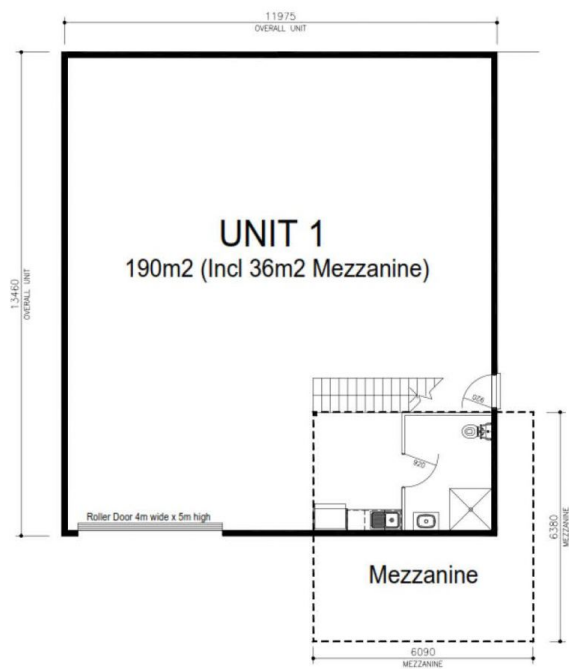

RISE PROJECTS

GROUND FLOOR AREA
MEZZANINE AREA
TOTAL AREA

UNIT 1
154m²
36m²
190m²

DISCLAIMER: The plan shown is a depiction of the floor plans. Due to the shape of the building, each floor plan will vary slightly. This document provides general information only, including illustrations, computer-generated images and forward-looking statements which are made on the basis of currently-available information and reasonable beliefs, but are subject to change at any time without notice. All properties are subject to contract and availability. The area (in square meters) is approximate. To the extent permitted by law, Rise Projects Pty Ltd and its related companies, directors and employees exclude all representations, warranties and liability whatsoever (including negligence) in connection with this document.