

## 2/15-17 Charles Street St Marys NSW



PRD Commercial in conjunction with CBRE have been appointed Exclusive Marketing Agents to offer the prestigious new Rise Industrial Estate located at 15-17 Charles St, St Marys.

Mezzanine 30m2\*  
Ground floor 141m2\*  
Total 171m2\*

Strategically located in the heart of the St Marys Industrial Precinct is an integral part of the Western Sydney growth corridor. Just 5kms\* to St Marys station, 7kms\* to the M4 Motorway and only 18kms\* to the new Badger Creek Airport site.

The property features the following:

**Building Size** : 171 sqm  
**View** : <https://www.prdcommercialwest.com.au/sale/nsw/western-sydney/st-marys/commercial/industrial/5615939>



**Robert Tappouras**  
02 4732 3711

RISE INDUSTRIAL ESTATE



4/1/2020

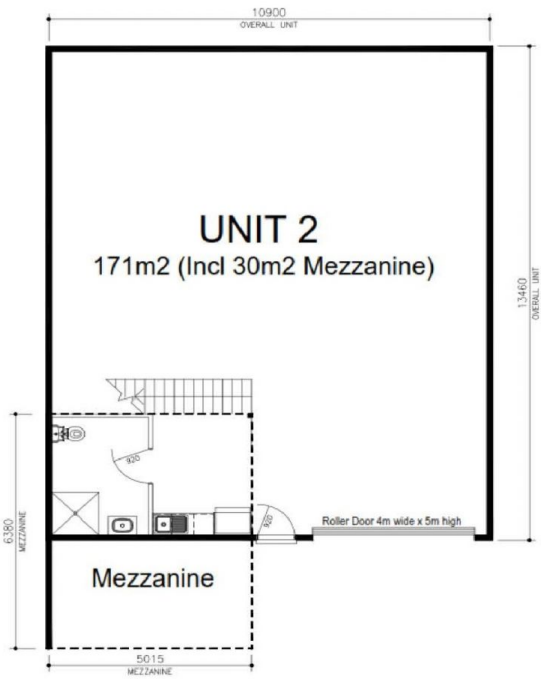

	UNIT 2
GROUND FLOOR AREA	141m <sup>2</sup>
MEZZANINE AREA	30m <sup>2</sup>
TOTAL AREA	171m <sup>2</sup>

DISCLAIMER: The plan shown is a depiction of the floor plans. Due to the shape of the building, each floor plan will vary slightly. This document provides general information only, including illustrations, computer-generated images and forward-looking statements which are made on the basis of currently-available information and reasonable beliefs, but are subject to change at any time without notice. All properties are subject to contract and availability. The area (in square meters) is approximate. To the extent permitted by law, Rise Projects Pty Ltd and its related companies, directors and employees exclude all representations, warranties and liability whatsoever (including negligence) in connection with this document.